

NOTE / NOTA:  
SIGNIFICANCE CATEGORY OF BUILDING C (NORMAL) -ACCORDING TO HGR 766. / CATEGORIA DE IMPORTANTA A CONSTRUCTIEI C (NORMALA) -CONFORM HGR 766.  
SIGNIFICANCE CLASS OF BUILDING III -ACCORDING TO P100. / CLASA DE IMPORTANTA A CONSTRUCTIEI III -CONFORM P100.  
AMOUNT OF FIRE RESISTANCE OF BUILDING III -ACCORDING TO TABLE 2.1.9. OF NORMATIVE P118/99. / GRADUL DE REZISTENTA LA FOC AL CONSTRUCTIEI III -CONFRM TABEL 2.1.9. DIN NORMATIVUL P118/99.

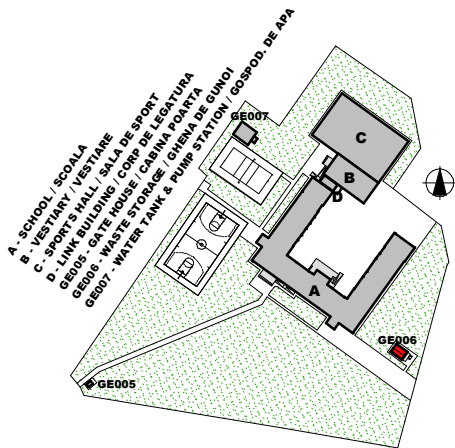

BUILD- UP AREA ON GROUND= 17.8 SQM  
TOTAL BUILD-UP AREA= 17.8 SQM  
SUPRAFATA CONSTRUITA= 17.8 MP  
SUPRAFATA CONSTRUITA= 17.8 MP

REMARK: ALL MASUREMENTS WILL BE TAKEN AT THE CONSTRUCTION SITE.  
NOTA: TOATE MASURATORILE SE VOR FACE LA FATA LOCULUI.

M.L.P.A.T. VERIFIER VERIFICATOR M.L.P.A.T.		NAME NUME	SIGNATURE SEMNTURA	REQUEST CERINTA	REPORT / EXAMINATION NO / DATE REFERAT / EXPERTIZA NR. / DATA
PROJECT DESIGN COORDINATOR: COORDINATOR PROIECT:					
BUCHAREST SCHOOLS INFRASTRUCTURE REHABILITATION / REABILITAREA INFRASTRUCTURII EDUCATIONALE IN MUNICIPIUL BUCURESTI					
DESIGNER/PROIECTANT:		M4			
		M3			
		M2			
		M1			
		Modif	Date/Dat a	DESIGNED BY/PROIECTAT	VERIFIED BY/ VERIFICAT
BENEFICIARY/BENEFICIAR MUNICIPALITY OF BUCHAREST PRIMARIA MUNICIPIULUI BUCURESTI		SCHOOL NAME/ NUME SCOALA	GENERAL SCHOOL NO. 36 / SCOALA GENERALA NR. 36		
DESIGNED BY PROIECTAT	NAME/ NUME arh. Andreea Bortoi	SIGNAT./SEMNTURA	TYPE OF WORKS/ LUCRARE	ARCHITECTURAL WORKS / LUCRARE DE ARHITECTURA BUILDING GE006 -ECOLOGICAL WASTE STORAGE CLADIRE GE006 -GHENA ECOLOGICA	
VERIFIED BY VERIFICAT	arh. Sorin Ichim		TITLE/ PLANS	GROUND FLOOR PLAN PLAN INVELITOARE	
PROJ. DIR. SEF PROIECT	arh. Daniel Hoinarescu				
DATE/ DATA 07 / 2006	SCALE/ SCARA 1:50	EXEMPLAR NR.	PROJ. PHASE/FAZA PROIECT Detailed Design Proiect tehnic	PROJ. No./Nr.PROIECT 063/S4	DRWG. No./Nr. PLANS GE006-AR-001
It is prohibited to copy, multiply or print this document without written approval of THE LOUIS BERGER GROUP, INC. Este interzisa copierea, multiplicarea si imprumutarea documentatiei fara aprobarea scrisa a THE LOUIS BERGER GROUP, INC.					